



*C-Build by CORNIX:
storage systems for life!*

C-BUILD

Cornix is manufacturer of storage systems since 1958

C-Rack by CORNIX® • TECHNICAL CHARACTERISTICS

BEAMS

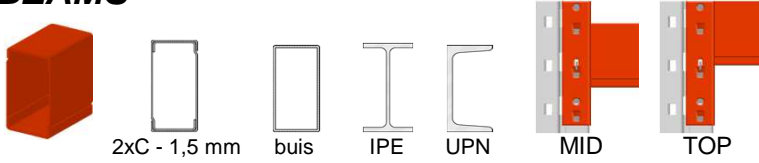

LOAD CHART PALLET LOADS in kg/pair of beams uniformly distributed (according to F.E.M. 10.2.02, maximum deflection 1/200). MID welded = - 38 mm (TOP takes less load). Pallets with regular interspaces on three blocks.

Max. load/connector : 1430 kg H : maximum height 1st level

H	type	50	60	70	80	95	110	127	140	160
L (mm)	S235	S235	S235	S235	S355	S355	S355	S355	S355	S355
1000	1352									
1000	1800									
1000	2250									
1000	2400									
1000	2700									
1000	3000									
1000	3300									
1000	3600									
1000	3900									
1500	1352									
1500	1800									
1500	2250									
1500	2400									
1500	2700									
1500	3000									
1500	3300									
1500	3600									
1500	3900									
2000	1352									
2000	1800									
2000	2250									
2000	2400									
2000	2700									
2000	3000									
2000	3300									
2000	3600									
2000	3900									
2500	1352									
2500	1800									
2500	2250									
2500	2400									
2500	2700									
2500	3000									
2500	3300									
2500	3600									
2500	3900									
3000	1352									
3000	1800									
3000	2250									
3000	2400									
3000	2700									
3000	3000									
3000	3300									
3000	3600									
3000	3900									

Due to important changes in the EN 15512 standard in 2020 all previous load charts are no longer valid.

Choose the beams first, then the frames. Beams double C welded MID (-38).

Load charts are only valid for static storage systems in seismically inactive areas.

FRAMES (bolted)

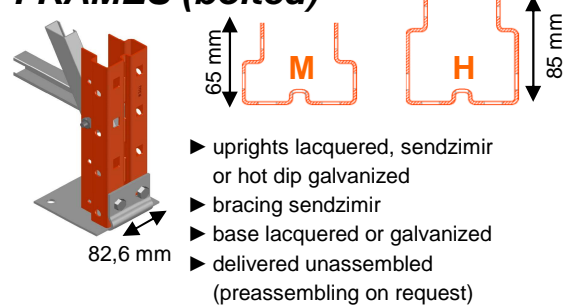

- ▶ uprights lacquered, sendzimir or hot dip galvanized
- ▶ bracing sendzimir
- ▶ base lacquered or galvanized
- ▶ delivered unassembled (preassembling on request)

Upright Steel type	M225 S355	M225 S390	H250 S355	H250 S390
1st level at max. (mm)	750			
	1000			
	1250			
	1500			
	1750			
	2000			
	2250			
	2500			
	3000			

Maximum load per frame with 2700 mm beams.

S175 = 1,75 mm / M225 = 2,25 mm / H250 = 2,50 mm

Steel quality : S355: lacquered or galvanized uprights

S390: sendzimir uprights

C-Rack by Cornix is a 100 % Redirack compatible product.

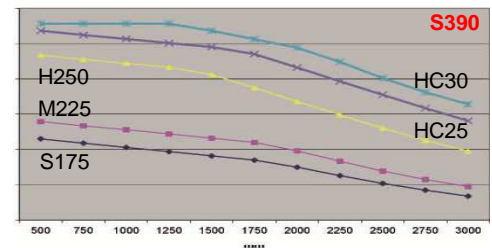
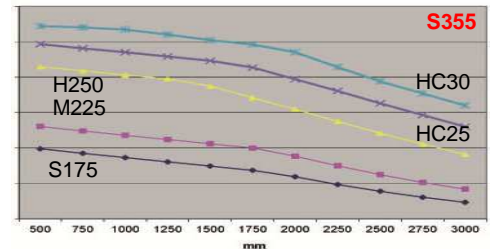

- 1 A three sided clamping of the upright guarantees a perfect transmission of the beam load onto the upright.
- 2 Six or eight hooks per connector guarantee an optimal beam stability.
- 3 A galvanized safety pin guarantees the interlock with the beam.

C-Build by CORNIX® • COVERED STORAGE

Bespoke
on request
MEASUREMENTS

2 versions : Pergola or Saddle Roof

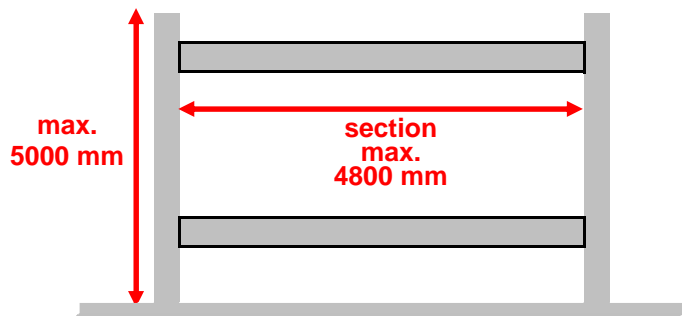
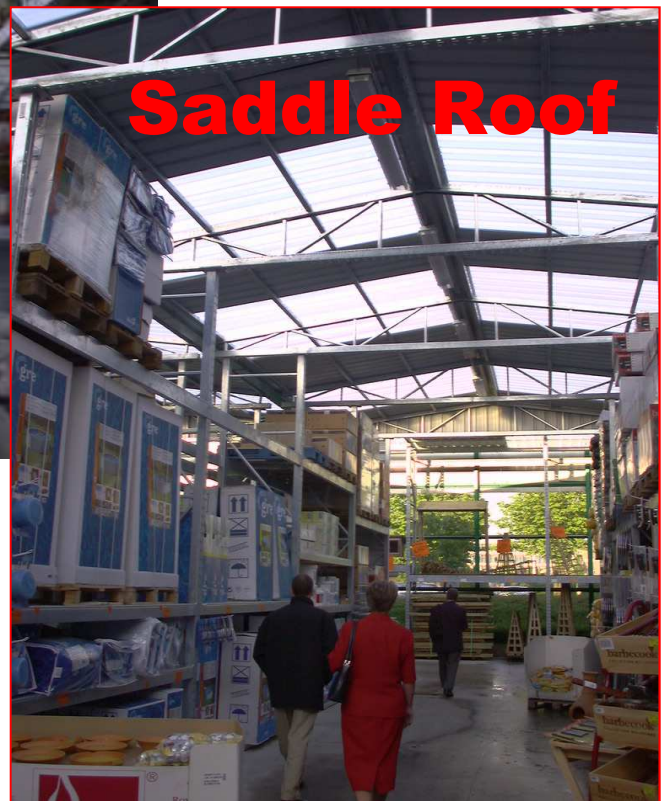

C-Build by CORNIX® ACCESSORIES



Roof panel partially transparent or full panel.

Gutters made to measure.



Protections.



Shutting with strip curtains, hinged or sliding doors.

C-Build by CORNIX® ACCESSORIES

Panelling as protection or shutting.

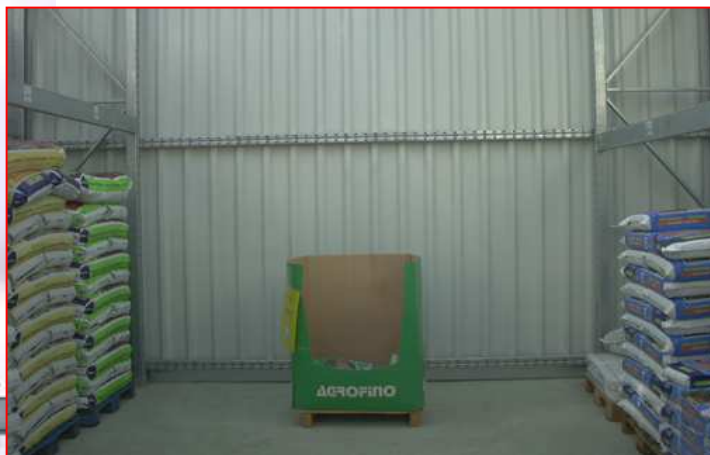

Also industrial applications :

- ▶ storage areas
- ▶ car ports
- ▶ bicycle parking ...



C-Build by CORNIX® : instant building at minimal cost. And easy to dismantle !



INDUSTRIAL ACCESSORIES

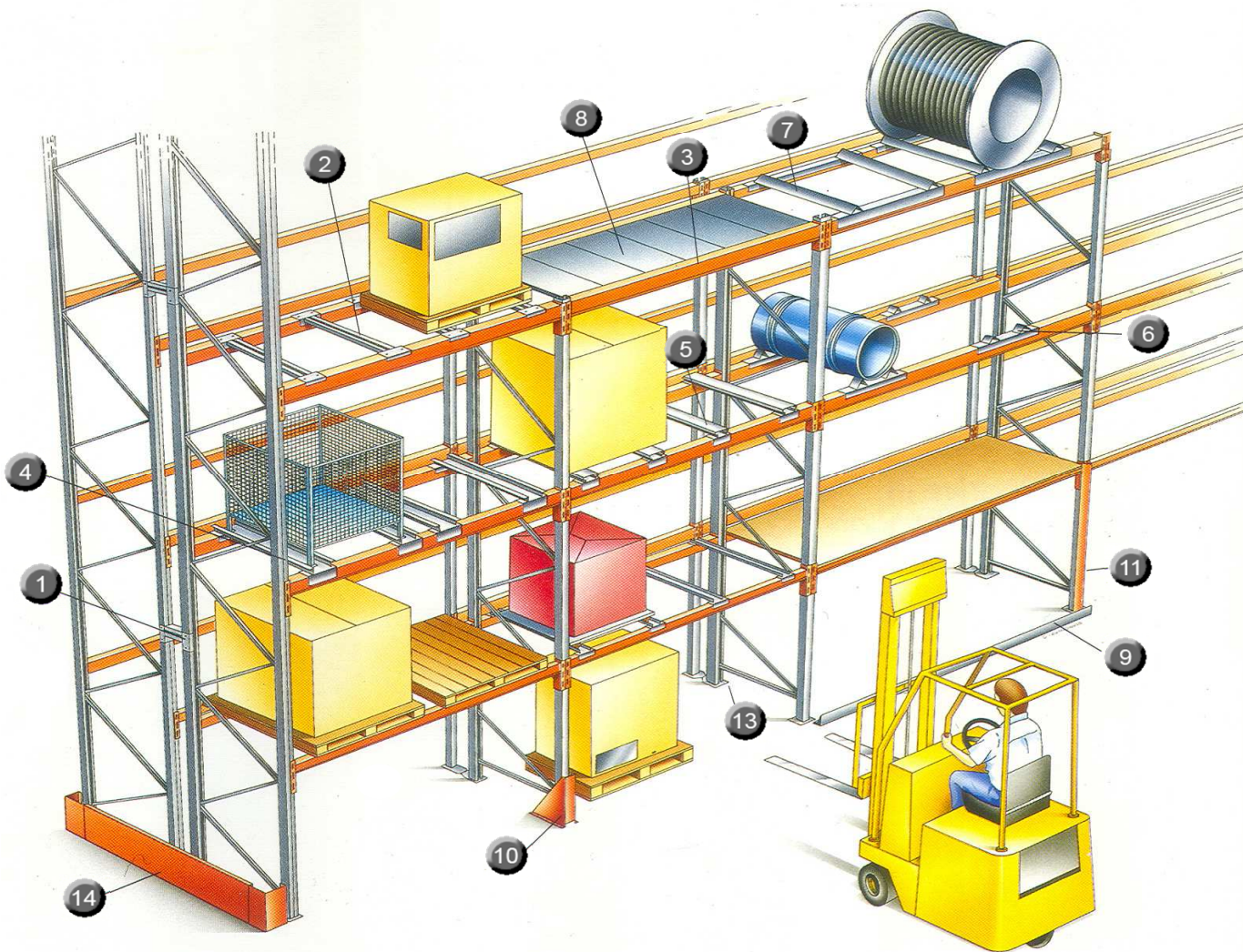

- 1 Frame tie
- 2 Shelf support
- 3 Beam with welded angle
- 4 Pallet skid channels
- 5 Raised shelf support
- 6 Drum cradle
- 7 Drum cradle (chassis)
- 8 Steel shelf
- 9 Section protector Toblerone
- 10 Upright protector
- 11 Upright protector
- 12 Sprinkler brackets
- 13 Steel bases
- 14 Lateral protector Ikea
- 15 Grid shelves
- 16 Wooden shelf
- 17 Safety stops

to keep the frames on a perfect distance and to increase stability.

to support pallets or a wooden shelf.

to install sunk shelves.

for an efficient storage of containers.

to store non palletized goods.

for storage of e.g. drums or cable drums.

this drum cradle supports the drum on the full depth.

modular sunk shelf 149 mm wide.

to protect an entire section from collision damage.

different models available to protect the uprights.

protects the upright over a height of 600, 900 or 1200 mm.

with or without rubber.

for single sided or double sided racks.

for a better distribution of the point loads.

also bigger base plates available (full frame depth).

to protect the lateral side of the frame against collision damage.

the ideal solution to avoid falling items and/or in case of sprinkler installation.

for some applications a wooden vented shelf may be the right solution.

avoids pushing your pallets to far. Special model for sprinklers. (18)

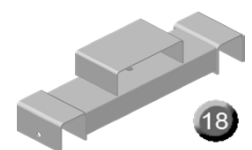
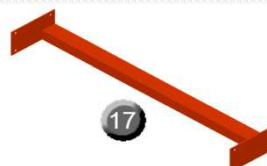
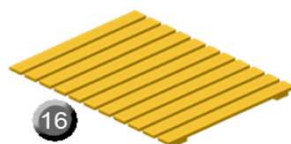
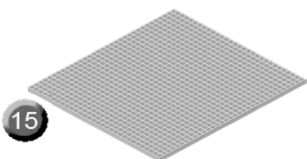
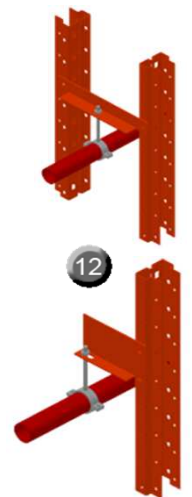

UPRIGHT & FRAME PROTECTIONS

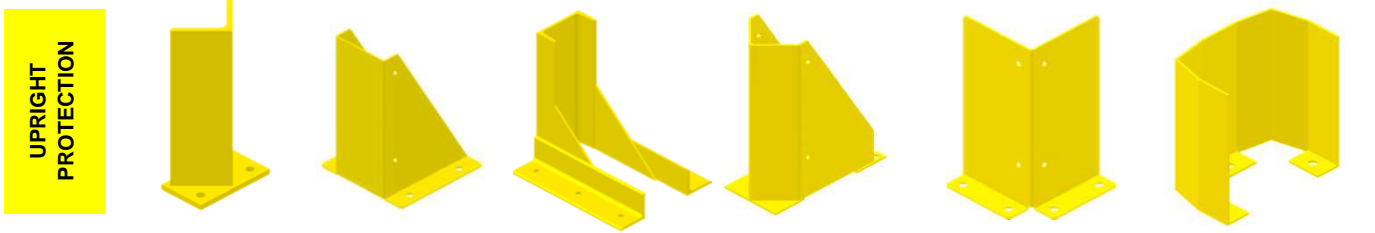

TYPE	light duty	medium	heavy duty	gib	angle	brico
H (mm)	400	40	400 or 600	400	400	250
Anchors	2	4	6	3	4	3

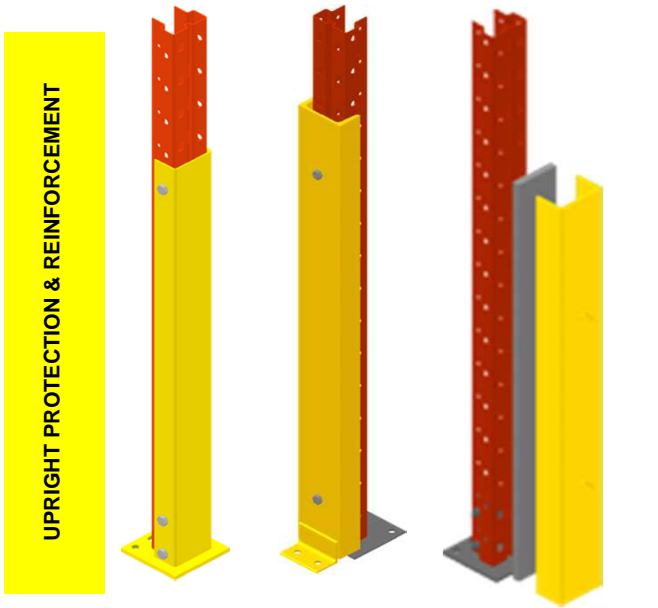

TYPE	raised base	upright protector with anchor	upright protector with rubber
H (mm)	190 600 900 1200	600 900 1200	600 900 1200

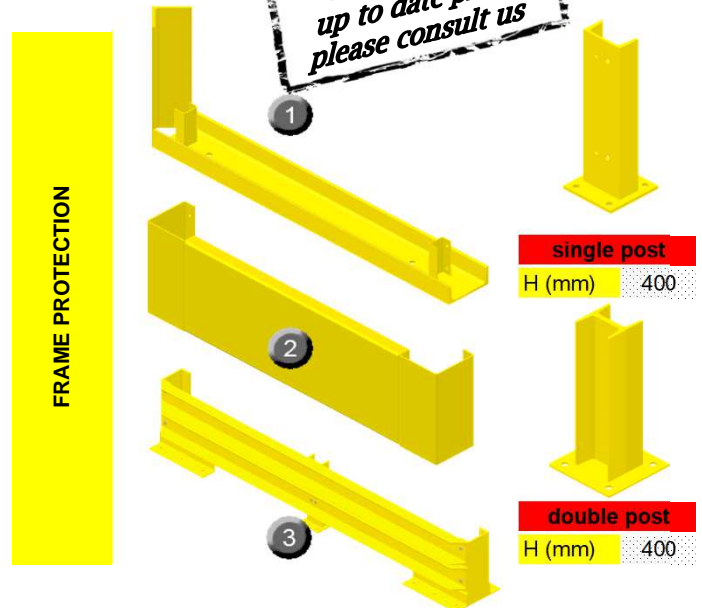

TYPE	continuous upright protection	ikea	frame protection upn
H (mm)	1 400	2 400	3 100 140

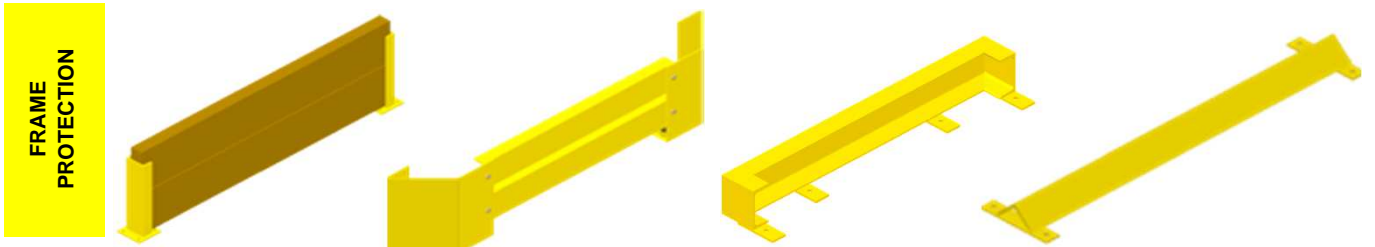

TYPE	wooden beam	shock absorbing beam	low beam	toblerone
H (mm)	400	400	150	45

C-Build by CORNIX® • DIY & GARDEN

Bespoke on request



DIY & GARDEN ACCESSORIES

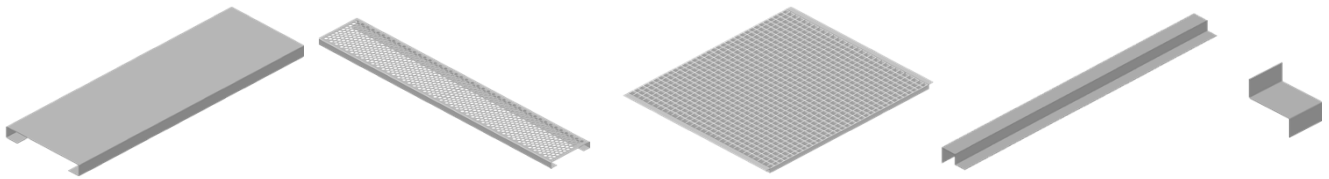

mm	steel shelf	steel shelf slotted	grid shelf	shelfholder sunk	shelfholder
L	600 >>> 1200	600 >>> 1200	bespoke	895	50
W	149 & 224	149 & 224			

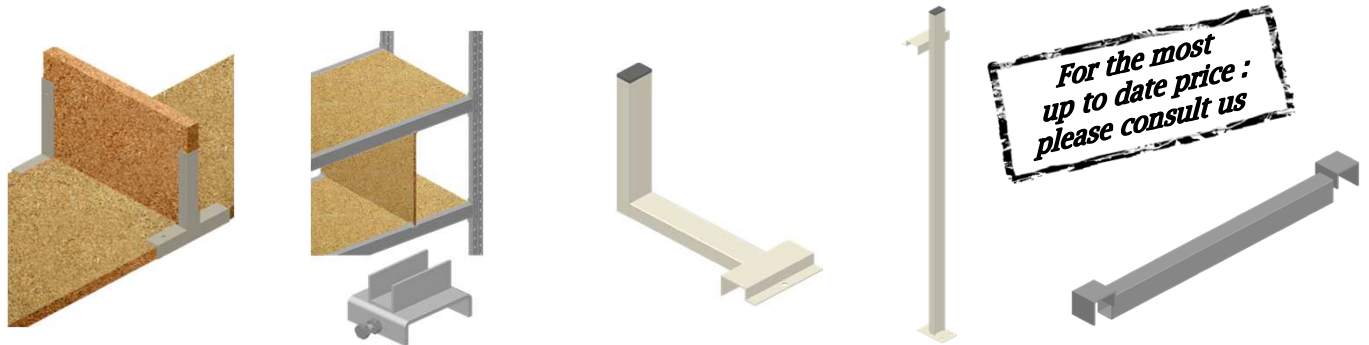

mm	brace for divider	clip for divider	offset safety stop (installation on beam)	post with safety stop	shelf support (sunk)
L	150	50	250	150	600 >>> 1200
H	150		150	1480	60

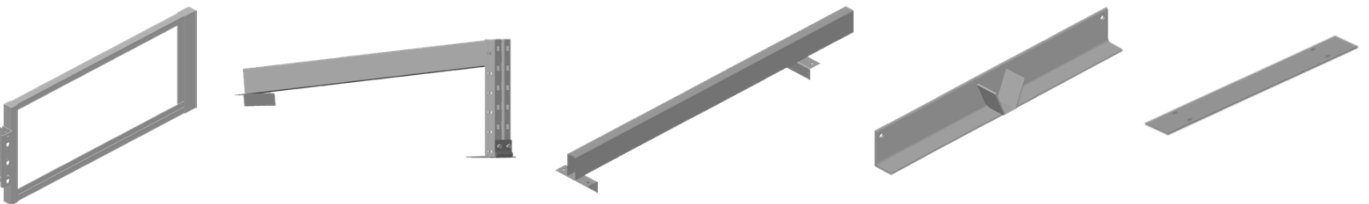

mm	sign holder	panel holder	overhanging support bar	cabledrum bracket	steel baseplate asphalt
L	800	1300	1000/1300	600 >>> 1100	1050 >>> 1350
H	400	450	100	100	10

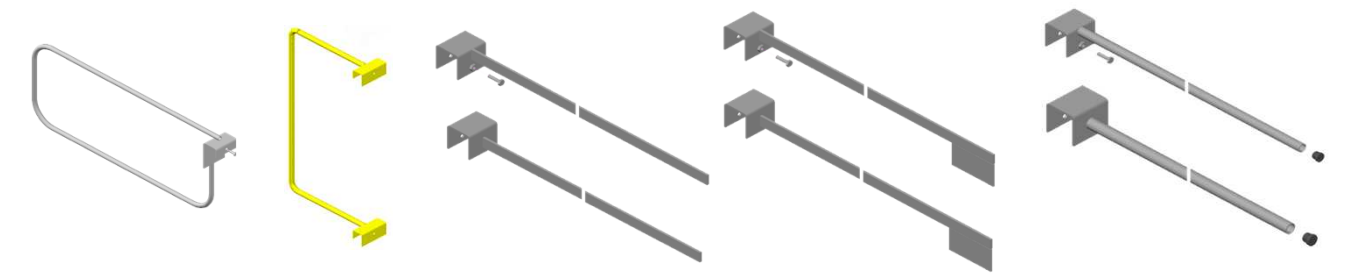

mm	divider frame single beam	divider frame double beam	divider arm flat (with or without bolt)	divider arm flat + flag (with or without bolt)	divider arm round (with or without bolt)
L	875	450 & 700	550 & 800	550 & 800	550 & 800
H	375	450 & 900	25	25 + 55	20

Delivered unassembled. Easy installation : assemble frames (on request frames can be supplied assembled), hang in the beams and put the safety pins in place. On request our specialized installers can install your C-Build® pallet racking installation. Ask for a free quote !

WHAT SHOULD YOU KEEP IN MIND ?

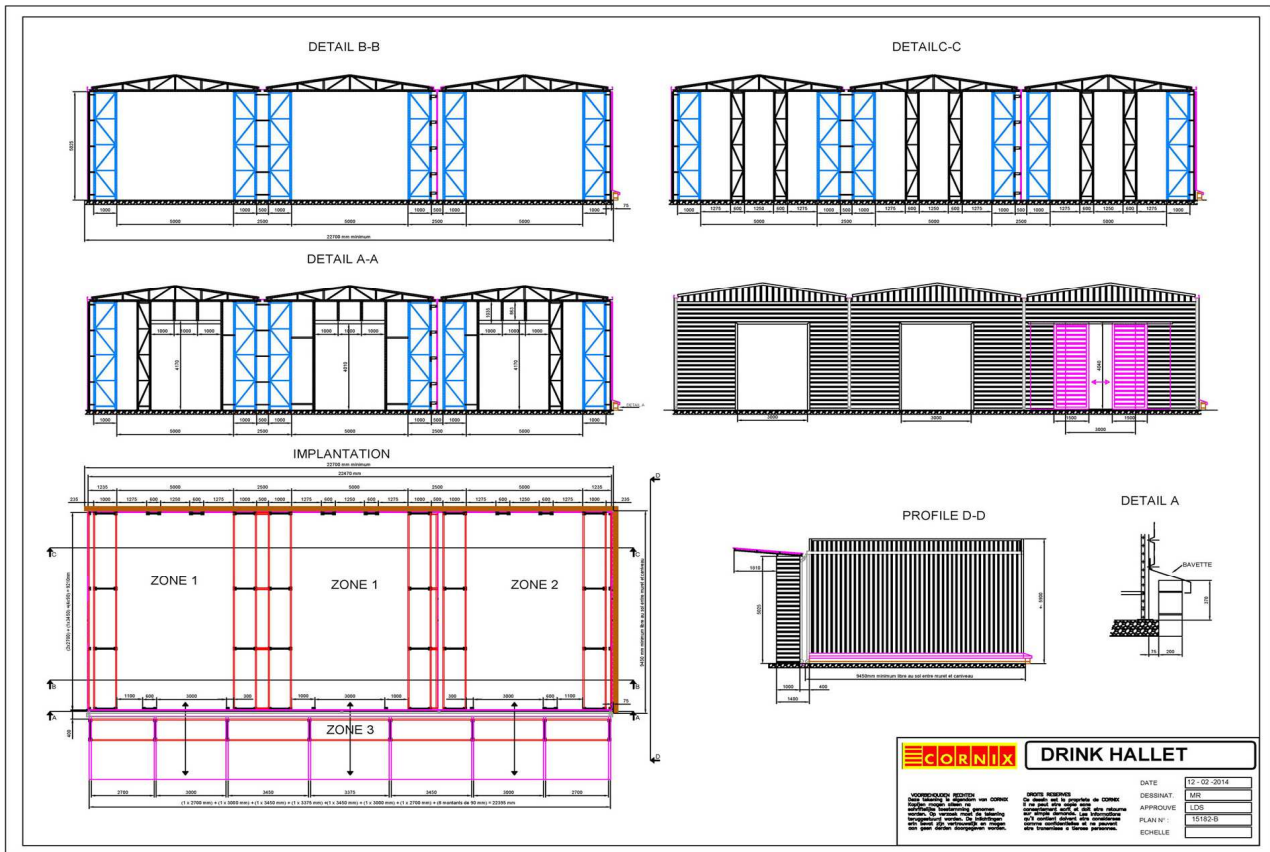

The permits :

Enquire at the technical department of your municipality whether a building permit is required. A C-Build © is removable, therefore usually there will be no building permit required. But it's better to be sure.

The floor slab :

You must provide a level concrete slab that can carry the point loads. We can inform you about these point loads and the standards for the level of your slab. A C-Build © can not be installed on loose soil, on a asphalt base or e.g. on cobblestones. A level concrete slab is a conditio sine qua non.

The drawings :

When ordering, we will provide you with a free drawing. If you need drawings in order to obtain your building permit we can provide these at costing price. When ordering this amount will be reimbursed.

HOW TO CALCULATE THE LENGTH OF YOUR INSTALLATION ?

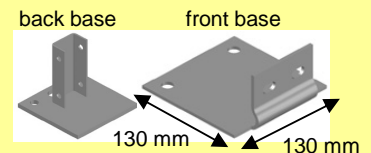
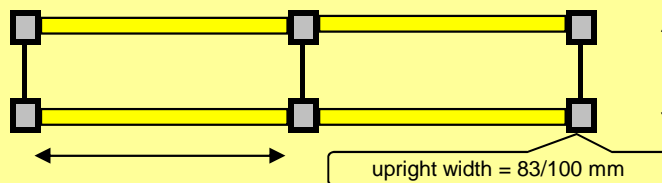

distance between uprights =
length beam b.v. 2700 mm : $2700 + 2 \times 3,5$ (connectors) = 2707 mm

don't forget to add :

- ▶ the upright width : S175/M225/H250 : 83 mm
H100 : 100 mm
- ▶ the overhang of the base plate (50 mm once for the total length of your installation).

example :

redirack upright 83 mm 2 bays of 2700 mm make : $2 \times 2707 + 3 \times 83 = 5663$ mm + 50 mm overhang base plate = 5713 mm
redirack upright 100 mm 2 bays of 2700 mm make : $2 \times 2707 + 3 \times 100 = 5714$ mm + 30 mm overhang base plate = 5744 mm

C-Build by CORNIX® & TRAVICANT®

Bespoke on request



Easy arm installation.

Galvanized TraviCant® with roof for exterior storage.

Each TraviCant® is especially designed for you : our computer calculates the best technical solution for your needs at the best price. Ask for a free quote !

Installation is easy & fast : bolt the arms and base to the column. Fix the bracing to the column and raise the whole lot. Changing positions of arms afterwards doesn't require the removal of the higher positioned arms. Special roofarms connected by beams carry the roof panels.



HOW TO CALCULATE THE DIMENSIONS OF YOUR INSTALLATION ?

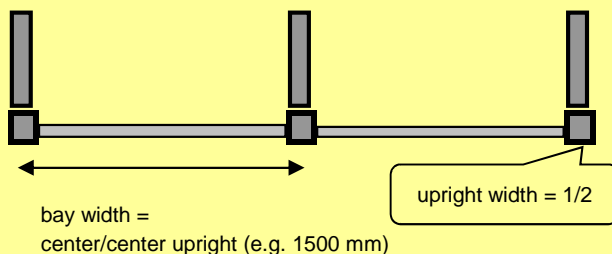

depth base = useful depth
base + 100 mm + upright depth
overall depth arm = usefull
depth arm + 10 mm

don't forget :

- ▶ to add 1 upright width
- ▶ depth base = depth upright

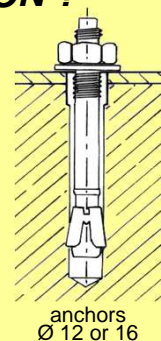

example :

2 bays of 1500 mm center/center make : 2x1500 + 1x upright width

e.g. upright width IPE220 = 110 mm



EUROPE'S FIRST MANUFACTURER OF STORAGE SYSTEMS



YOUR CHOICE OF COLOURS

Standard colour for this product (+/- 6 weeks) :

Hot dipped galvanized

(bracing & small items : sendzimir)

As this product is only used for exterior applications only a hot dipped galvanized version is available.

All accessoires are also hot dipped galvanized

or electro galvanized for some smaller parts.

All accessories such as e.g. shelves are manufactured out of sendzimir steel.

Lacquered version not available.

Roof and partition panels are provided in sendzimir steel sheet

lacquered grey or green with the underside in off-white

for better light reflection.

OTHER CORNIX® PRODUCTS

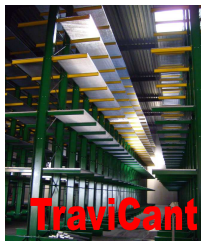

TraviCant
Cantilevers



C-Cable
Cable drum storage



TraviDrive
Drive-in & drive-through



C-Rack
Pallet racking



Cornix Plus
Shelving systems



TraviForm
Mezzanines

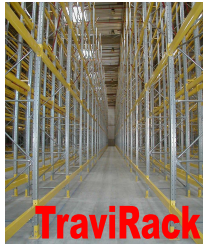

TraviRack
Pallet racking

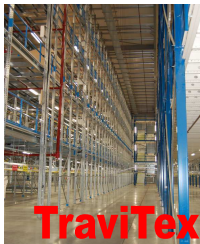

TraviTex
Garment storage



TraviRoll
Dynamic storage



Minirack Plus
Long span



STORAGE SYSTEMS FOR LIFE

www.cornix.eu

CORNIX FLANDERS

ANTWERPEN (Kiel)

Boomsesteenweg, 492

B-2020 Antwerpen

☎ ++/32/(0)3/240 11 30

☎ ++/32/(0)3/825 30 90

✉ sales@cornix.eu

CORNIX NETHERLANDS

DOETINCHEM (no showroom)

Kruidenlaan 7

NL-7060 TD Doetinchem

☎ ++/32/(0)3/240 11 30

☎ ++/32/(0)3/825 30 90

✉ sales.nl@cornix.eu

CORNIX WALLONIA

NIVELLES

Rue de la Recherche 6A, Z.I. 1 Nivelles Sud

B-1400 Nivelles

☎ ++/32/(0)67/411 241

☎ ++/32/(0)67/411 249

✉ sales@cornix.be

CORNIX EXPORT SALES

NIVELLES

Rue de la Recherche 6A, Z.I. 1 Nivelles Sud

B-1400 Nivelles

☎ ++/32/(0)67/894 225

☎ ++/32/(0)67/894 220

✉ export@cornix.eu